

MAIN DIMENSIONS

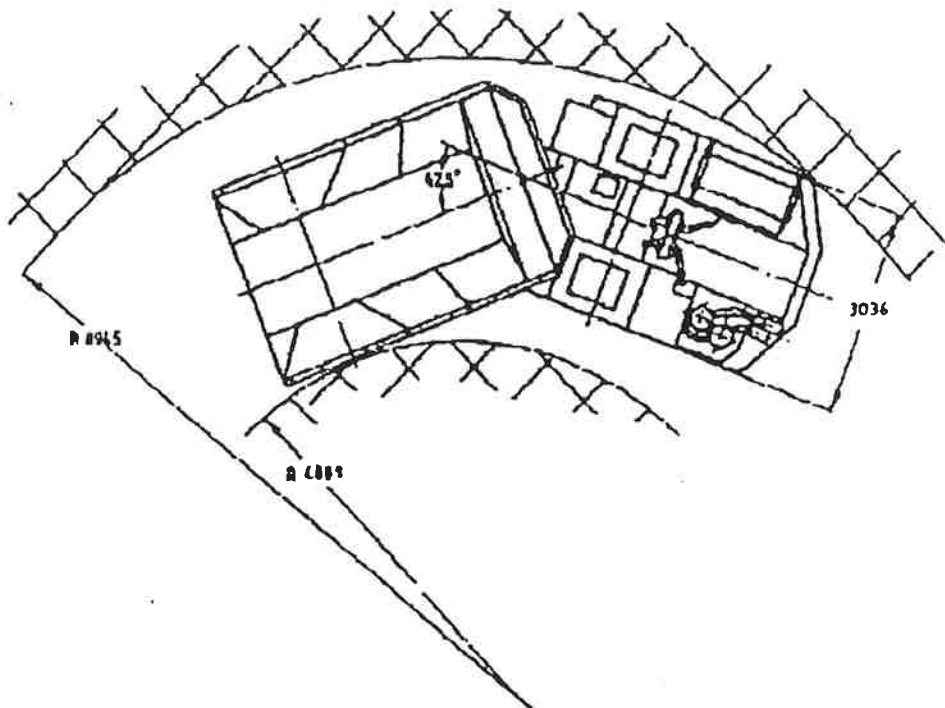
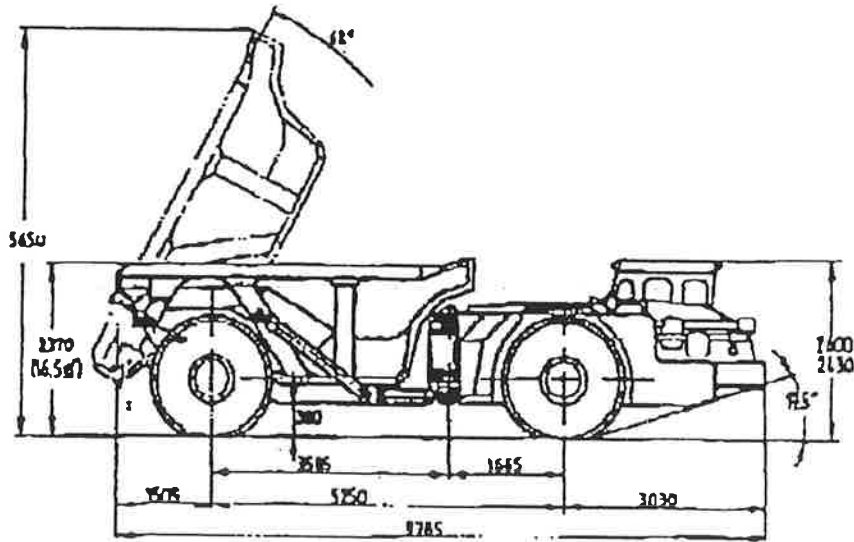

TECHNICAL SPECIFICATION

MAIN DIMENSIONS

Total length	8785 mm
Total width	3036 mm
Height	2430 mm
Height of the bed	2970 mm (with 16.5 m3)

WEIGHTS

Operating weight*	25300 kg
Total loaded weight*	61300 kg
Axle weights	
Without load	front axle 16600 kg
	rear axle 8700 kg
With load	front axle 26300 kg
	rear axle 35000 kg

CAPACITIES

Payload capacity*	36000 kg
Bed	12.5 - 20.0 m3

* Variations depending on the equipment

BED MOVEMENTS

Discharging time	18 s
Dumping angle	62 °

DRIVING SPEEDS FORWARDS AND REVERSE (LOADED)

1st gear	8.0 km/h
2nd gear	12.0 km/h
3rd gear	23.0 km/h

FRAME

Rear and front frame	Welded steel box construction
Material	Reax 384 (St 52-3)
Central hinge	Box constructed, adjustable lower bearing

BED

Welded steel box construction	
Material	Abrasion steel

ENGINE

Diesel engine	Detroit 60 series engine
Output	240 kW/2300 r/min (328 hp)
Torque	1160 Nm/1600 r/min
Number of cylinders	V 12
Displacement	18000 cm ³
Cooling system	Air cooled
Combustion principle	Swirl-chamber, four stroke
Air filtration	Oilbath and cyclone
Electric system	24 V
Exhaust gas purification	Catalytic purifier

TRANSMISSION

Torque converter	Clark CL 8502, one-stage transformation ratio 3.09:1
Offset	0.885:1
Gearbox	Clark 5420, Power Shift gearbox with hydraulic remote selection system three gears forwards and reverse
Axles, front and rear	Clark D 75720, rear axle oscillating • 10° front axle solid
Tyres, front and rear	26.5 x 25, E-3
Pressure	front
	rear
	450 kPa (4.5 bar)
	450 kPa (4.5 bar)

STEERING

Full hydraulic center articulated power steering with two double acting steering cylinders, turning angle • 42.5°. Steering system is equipped with Orbital servo control and steering wheel and with demand valve to make steering speed constant and autonomous from engine rpm.

Turning radius	Inner 4897
.....	outer 8945

Main components in steering system

Steering pump	Harnworthy Hydreco
Steering cylinders	ARA
Steering valves	Danfoss

Pressure setting for the steering hydraulics	17.5 MPa (175 bar)
shock load valves	24.0 MPa (240 bar)

BED HYDRAULICS

Full hydraulic servo controlled system, equipped with two gear pumps. Oil flows to bed hydraulic system from the main pump and from the steering hydraulics. Oil flow from the servo circuit pump is divided also to the oil cooler motor, brake cooling system.

Pressure setting for the	
servo circuit	2.5 MPa (25 bar)
bed hydraulics	18.0 MPa (180 bar)
shock load valves	21.0 MPa (210 bar)

Main components in bed hydraulics

Cylinders for bed hydraulics	ARA
Valves	Hamworthy Hydreco
Pump for bed hydraulics	Hamworthy Hydreco
Pump for servo circuit	Hamworthy Hydreco
Hydraulic oil tank capacity	appr. 200 l

BRAKE SYSTEM

Service and emergency brakes are fully hydraulic Clark liquid cooled brakes (LCB), two circuits for the service brakes and one for the emergency brake. Parking brake consists of two spring applied, hydraulically released drive line disc brakes.

ELECTRICAL EQUIPMENT

Alternator	28 V, 70 A, Motorola
Batteries 2 pcs	12 V 155 Ah
Starter	9.0 kW, 24 V, Bosch
Driving lights	2 pcs in front (H4 70W)
	2 pcs in rear (H1 70W)
Working lights	4 pcs (H1 70W)

OPTIONAL AND ADDITIONAL EQUIPMENT

Air filtration	PICO-zyclone, 16 m3 Donaldson
Exhaust gas purification	Diluter
Converter offset	1 : 1 (torque)
Body capacity	18.0 m3
Cabin with air conditioning	Halgitil 2430 mm
Cabin enforced according to ROPS	
Electric gear shift control	
Electric gauges	
Automatic central lubrication	ARA, hydr.
Cabin	170 mm higher
Thermal windows	
Tall gate	
Load measuring device	
Electrical retarder	TELMA
Protection plates for body and front frame	
CECAM monitoring system	

THE MEASURES AND WEIGHTS OF THE BIGGEST PARTS

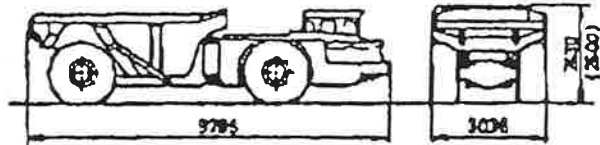

1. In full operating condition
Weight: 25500 kg

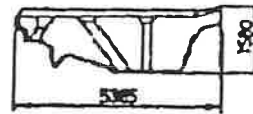

4. Bed 16.5m²
Weight: 4400 kg

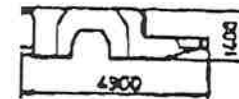
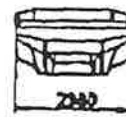

7. Front frame
Weight: 3500 kg

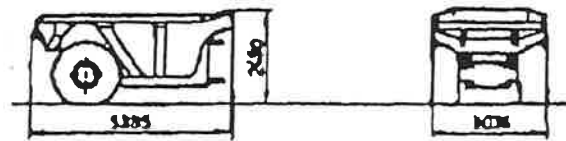
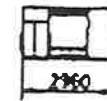

2. Rear part as whole
Weight: 11000 kg

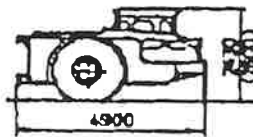

5. Front part as whole
Weight: 14500 kg

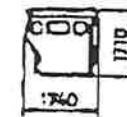
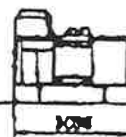

8. Cabin
Weight: 1200 kg



3. Floor frame
Weight: 2200 kg



6. Front part without
cabin and wheels
Weight: 11000 kg

